

INSTALLATION INSTRUCTIONS

Thank you for purchasing ADARAC™ Products. Agri-Cover, Inc. proudly manufactured this product using superior quality materials and workmanship. With proper care, your product will provide years of service and enjoyment.

NOTICE TO INSTALLER: Even if familiar with product, read instructions prior to installation as improvements may be made without notice. Always handle components with care. If you have questions or problems call customer service. When done, these instructions must be given to the consumer.

NOTICE TO CONSUMER: Before using this product, read maintenance and safety sections. Save these instructions for future reference.

FOR YOUR RECORDS

DATE PURCHASED: _____

WHERE PURCHASED: _____

SERIAL NUMBER: _____

(Located on side rail)



Questions? 866-630-8726
agricover.com

⚠ WARNING

ADARAC™ Truck Bed Rack, ADARAC™ Aluminum M-Series, ADARAC™ Aluminum Series, ADARAC™ Aluminum Pro Series and ADARAC™ Aluminum Upright Kits have a static load capacity of 1000 lbs., a dynamic load capacity of 500 lbs. and an off-road dynamic load capacity of 400 lbs., evenly distributed on ADARAC™ System including accessories. Always secure cargo properly. Failure to secure cargo or hauling inappropriate cargo may result in personal injury or death. Agri-Cover, Inc. is not responsible for any property damage, personal injury or death incurred while using any Agri-Cover, Inc. product.

⚠ CAUTION

These products are only intended for transporting cargo evenly distributed on an ADARAC™ System, including accessories. It is the responsibility of the user to secure these materials to the rack before transporting. Never load your rack to exceed the safe capacity of your vehicle.

Consult your vehicle's owner's manual for specifications on load ratings and recommendations for installation of aftermarket racks. Never exceed the lower load rating. Heavy loads when carried high can dangerously alter the center of gravity of your vehicle. Any modifications made to this product or use of this product for any other purpose than its intended use could create a hazardous condition that can cause serious personal injury or property damage.

NOTE

Before entering low clearance areas, check height and width clearance to ensure safe entry (empty or loaded).

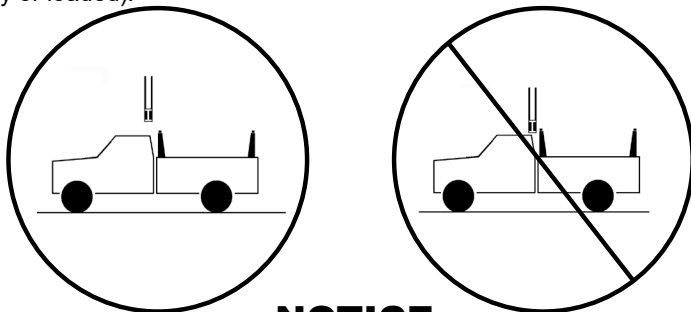

NOTICE

Any modification or unintended use of these products shall immediately void all manufacturer's warranties. Manufacturer disclaims all liability for injuries to persons or property resulting from any modification to or unintended use of these products.

Some vehicle manufacturers require a reinforcing kit, available through the vehicle dealership, to be installed on the truck box prior to mounting any kind of rack. Contact your dealership to see if your vehicle requires a reinforcing kit before installation.

NOTE: Installation and use of any box rail mounted accessory may cause minor aesthetic damage to exterior of vehicle. Agri-Cover, Inc. makes no claims or warranties as to a particular vehicle's ability to support rail mounted accessories without incurring damage. See your vehicle manufacturer's specifications for bed rail mounted accessories.

OVERVIEW

All ADARAC™ Truck Bed Racks and Kits support ACCESS® Roll-Up Covers.

ADARAC™ Aluminum Pro Series and Vertical Pro Upright Kits support full use of LOMAX® Folding Hard Covers.

PREPARATION

Clean truck box rails. For additional installation assistance, go to adarac.com for install videos.

RAIL COMPONENTS

- (2) Rails with hardware
- (4) Rail end caps with hardware
- Clamp plates (quantity varies)
- Alignment plates (quantity varies)

UPRIGHT COMPONENTS

- (4) Uprights with hardware
- (2) Cross bars with hardware
- (4) End caps with hardware
- (2) Stabilizing rubber
(Aluminum models only)

TOOLS NEEDED

- Protective eyewear
- Ratchet with 9/16" socket and extension
- Ft-lbs Torque wrench
- In-lbs Torque wrench
- Phillips screwdriver (rails only)
- Tape measure (uprights only)
- 9/16" Open end wrench - optional

⚠ CAUTION: Over torquing hardware may damage components.

SAFETY INFORMATION

- Read and adhere to safety warnings and cautions.
- Don't exceed weight rating of rack or upright kits and always distribute weight evenly.
- Don't exceed weight rating of truck.
- Always secure objects on ADARAC™.
- Always use caution when loading or unloading cargo.
- Team load and unload heavy or cumbersome objects.
- Always drive cautiously with cargo on ADARAC™. Additional weight changes dynamics of driving.
- Be aware of total vehicle height and width with ADARAC™ and cargo, ensure safe passage under any low clearances.
- Verify ADARAC™ and accessories are mounted securely before loading cargo or operating truck.
- Consult your vehicle's owner's manual for load ratings and recommendations of installation of aftermarket racks.
- If required, use dealer reinforcing kit.

PARTS DIAGRAM:
ADARAC™ ALUMINUM MODELS

NOTE: Hardware appearance and components may vary.

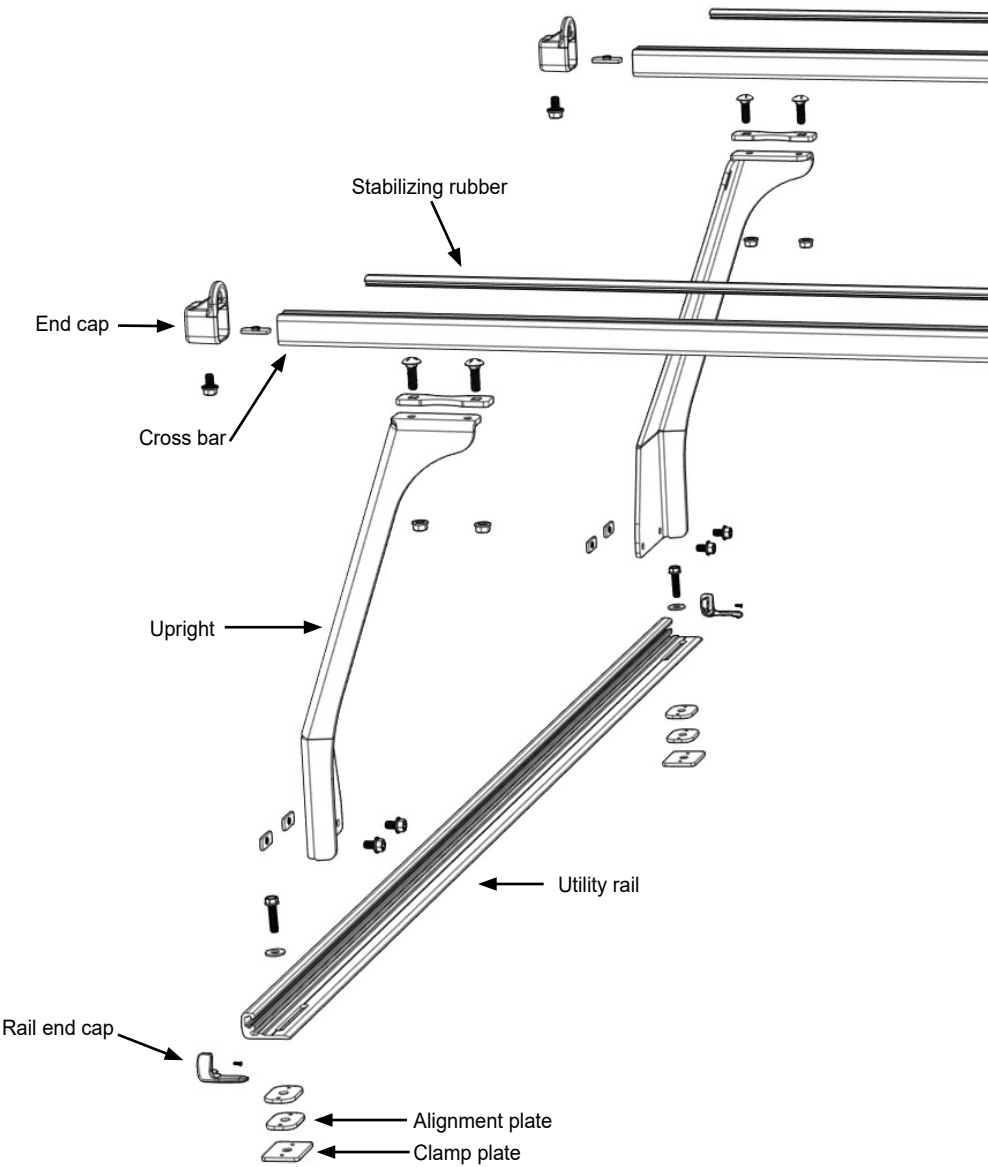

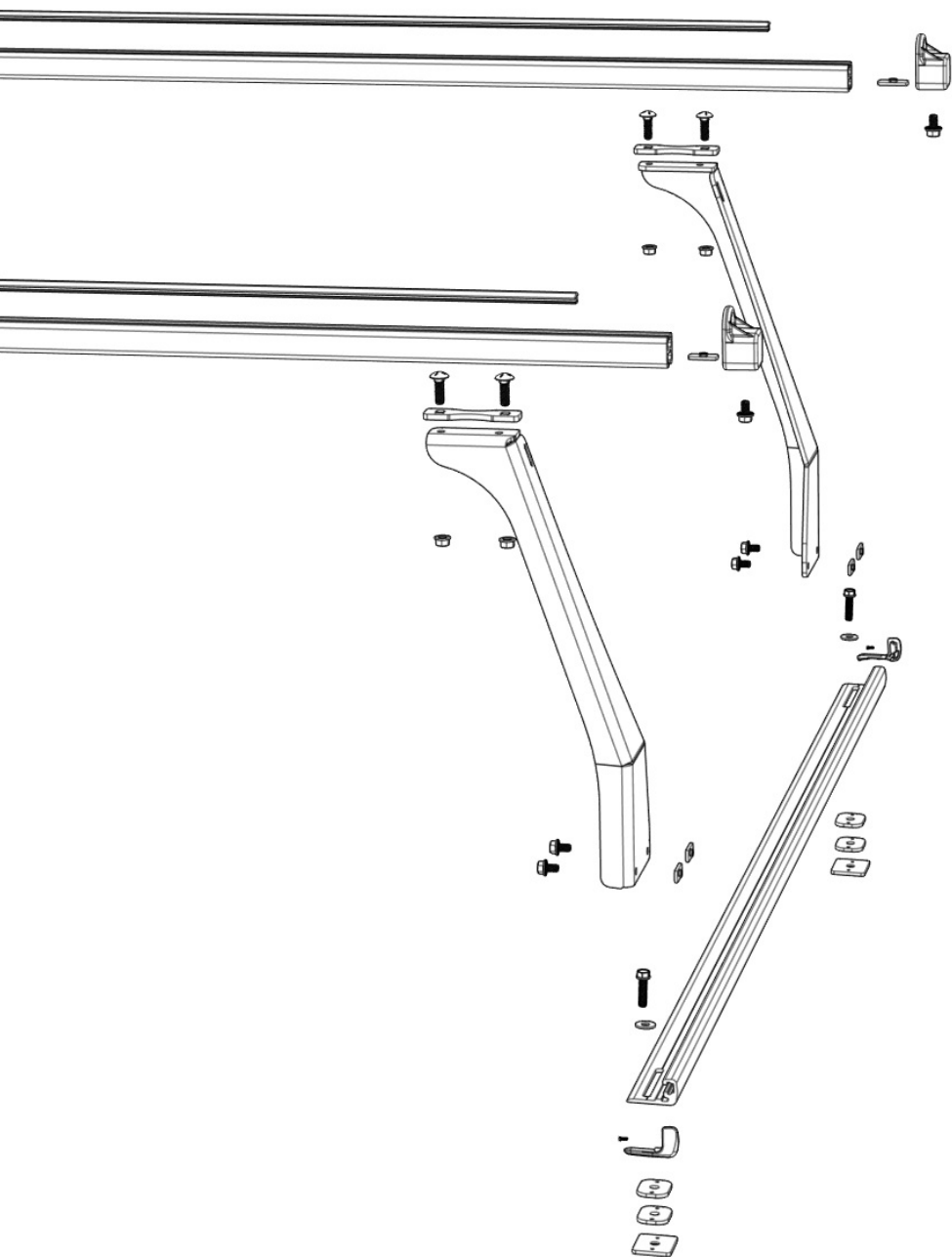

PARTS DIAGRAM: ADARAC™ TRUCK BED RACK

NOTE: Hardware appearance and components may vary.

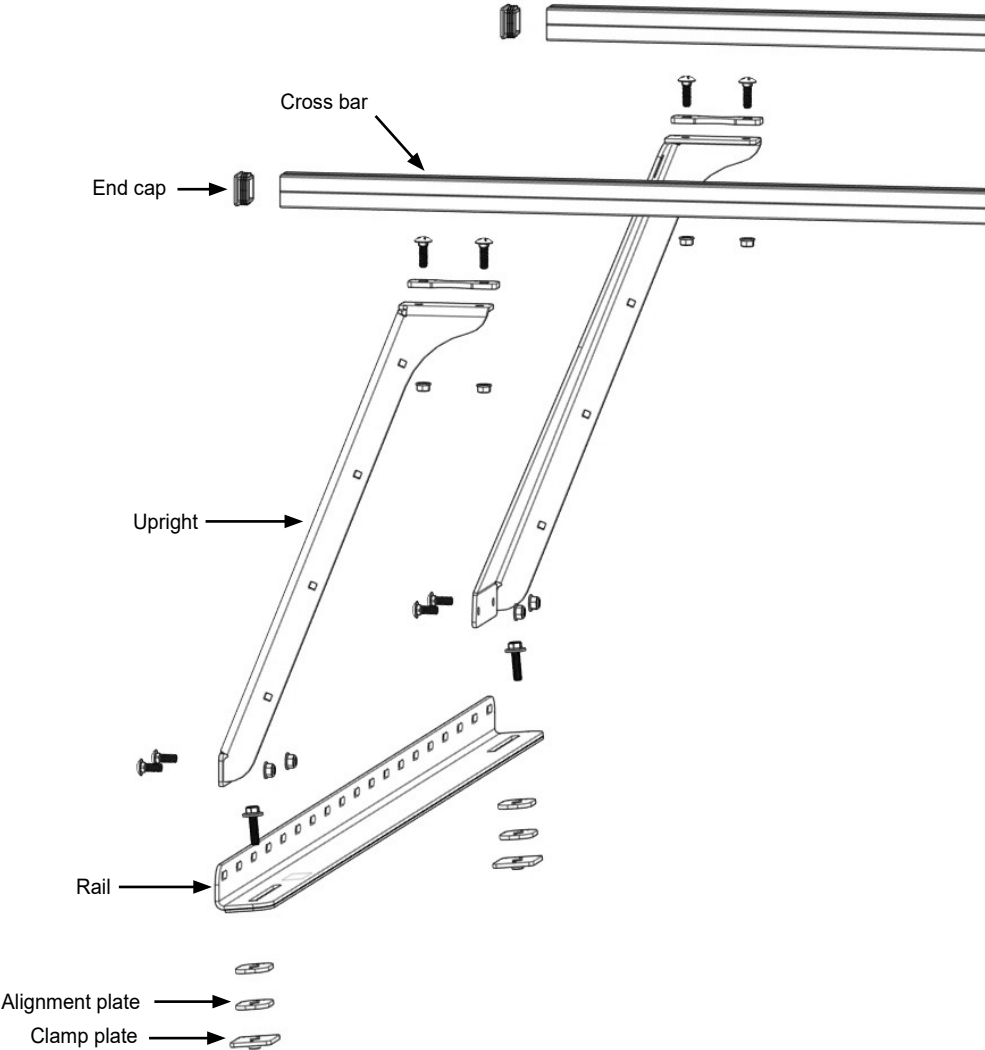

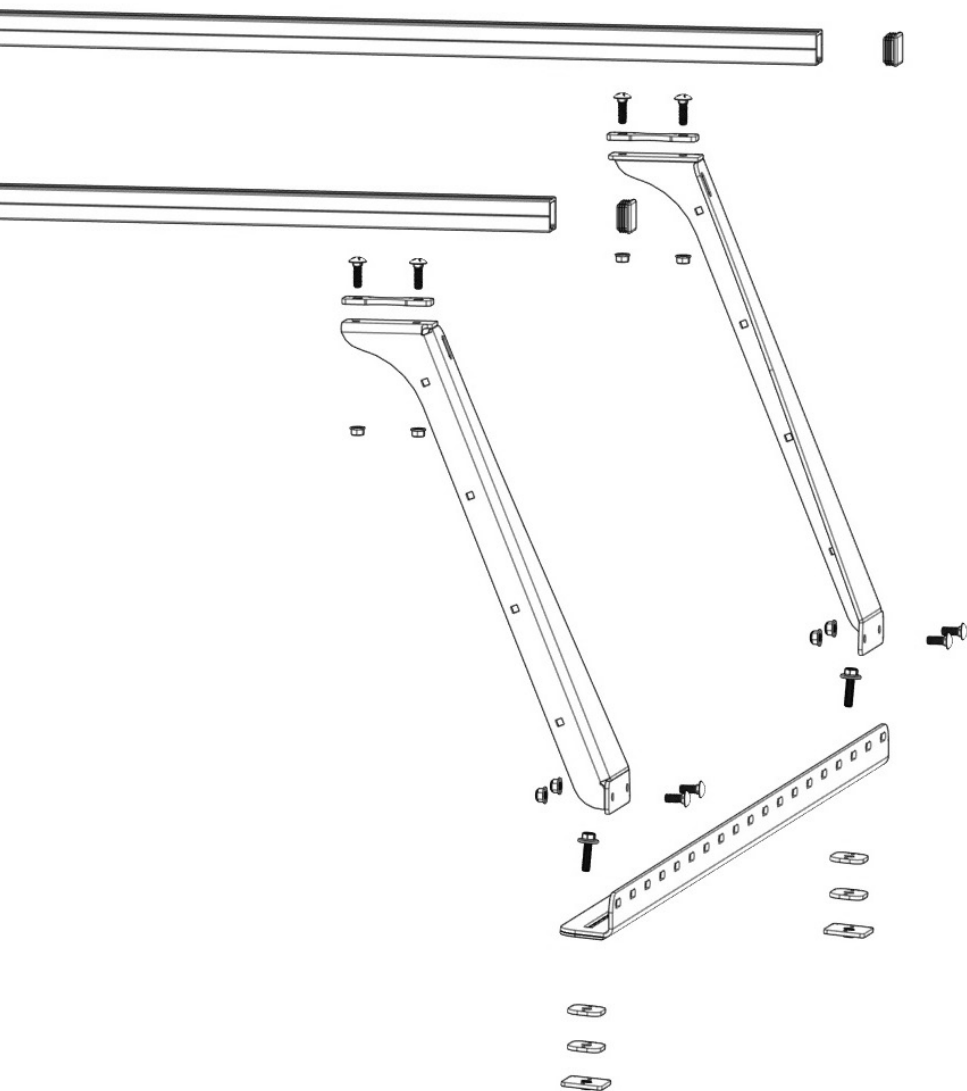

RAIL INSTALLATION

NOTE: For upright installation, see page 10.

1: PREPARING CLAMP ASSEMBLY AND RAILS

IMPORTANT: Stake pockets must be open to install this product. If stake pockets are not present, refer to special instructions.

NOTE: Corrosion resistant coating may cause hardware to thread firmly.

ASSEMBLE THREADED CLAMP

A. Loop cord around extended threads on clamp plate, add alignment plates equally, then tie knot at top of cord.

NOTE: Each cord should have a threaded clamp plate and one or more alignment plates.

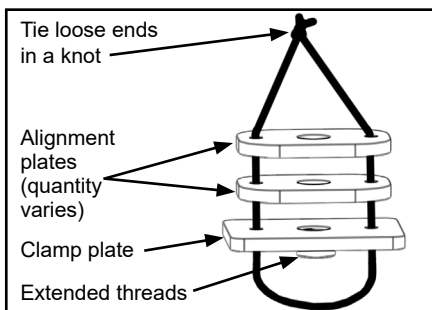

RAILS WITH MOUNTING CHANNELS

NOTE: If rails do not have mounting channels, proceed to Step 2.

A. Place rail on flat surface and insert (4) channel nuts with extended threads facing away from slotted hole.

Tip: If installing optional rail accessories, insert additional channel nuts to support the accessories. For more information see accessory instructions.

B. Insert rail end caps into both sides of rail.

C. Tighten rail end cap retaining screws with Phillips screwdriver.

D. Repeat Step 1 on opposite side.

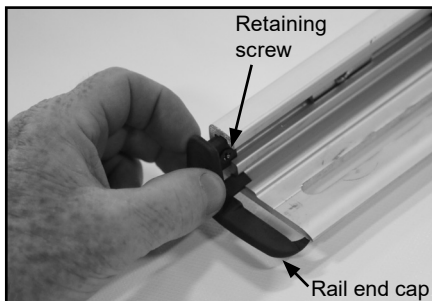
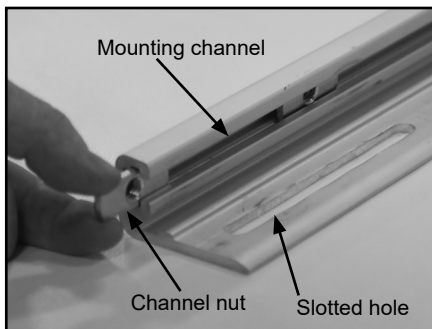

2: INSTALLING RAIL

A. Align rail and long slotted holes over stake pockets.

NOTE: Do not allow rail to pass front edge of box.



B. Lift rail until slotted hole is accessible from bottom. Route knot in cord under and through slotted hole, then drop clamp plate into stake pocket and lower rail.

IMPORTANT: Ensure extended threads on clamp plate are toward the box floor.

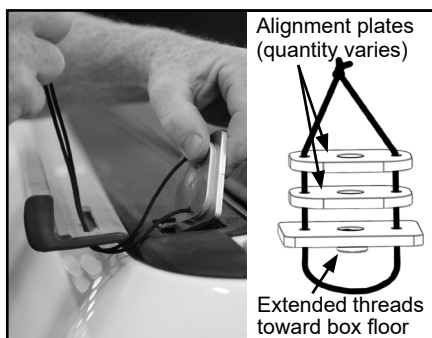

C. Move cord until clamp and alignment plates line up with stake pocket. Pull cord up until clamp and alignment plates are held against stake pocket and bottom of rail. Then turn $\frac{3}{8}$ " x 1- $\frac{1}{2}$ " hex bolt into threaded clamp until finger tight.

D. Repeat Steps 2A-C for front stake pocket.

NOTE: If middle stake pocket is present repeat Steps 2A-C.

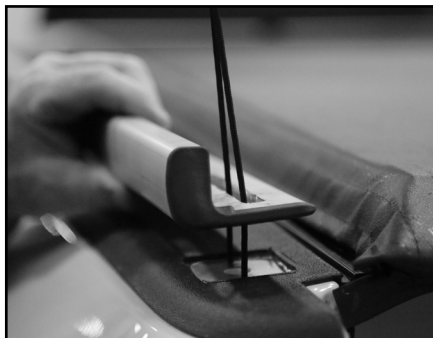

E. Slowly close tailgate to ensure it does not hit or rub against rail. If needed, adjust rail forward.

Tip: For easy removal of internal parts later, undo knot in cord, make single knots at each end and then push cord into stake pocket.

F. Remove cords and fully tighten all bolts with a ratchet and $\frac{9}{16}$ " socket until serrations on flanges are seated tightly.

G. Repeat Step 2 for rail on opposite side.



UPRIGHT INSTALLATION

1: PREPARING UPRIGHTS

A. Insert (2) 3/8" x 1-1/4" carriage bolts through mounting bracket and top of upright. Secure using serrated flange nuts, leave loose for now.

B. Repeat Step 1 for remaining uprights.

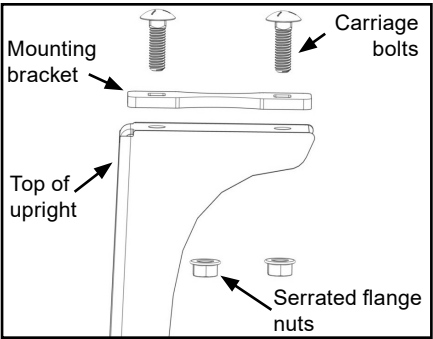

2: ASSEMBLING UPRIGHTS

IMPORTANT: Always measure upright locations. Truck boxes may vary from front to rear.

A. Measure and record mounting distance between inside rails at preferred locations.

NOTE: Upright mounting locations are user defined and vary based on application.

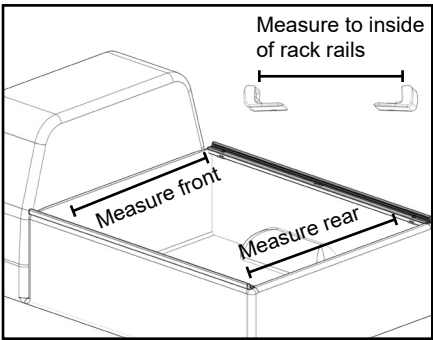

Tip: If installing optional cross bar accessories, insert mounting hardware on accessory into cross bar channel before attaching uprights. For more information see accessory instructions.

Tip: Attach uprights with mounting bracket to cross bar while components are on a flat surface.

B. Slide mounting bracket into bottom cross bar channel.

NOTE: Cross bar and upright appearance may vary.

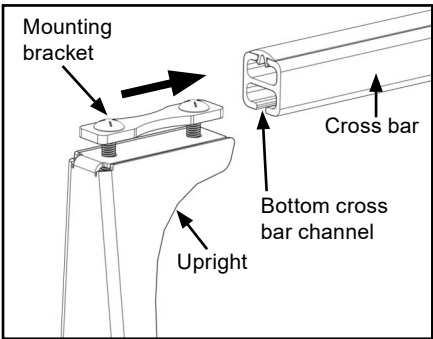

2: ASSEMBLING UPRIGHTS (Continued)

C. Space bottom of uprights to match measurement recorded earlier of distance between rails. Center cross bar then turn bolts snug enough to prevent cross bar slippage.

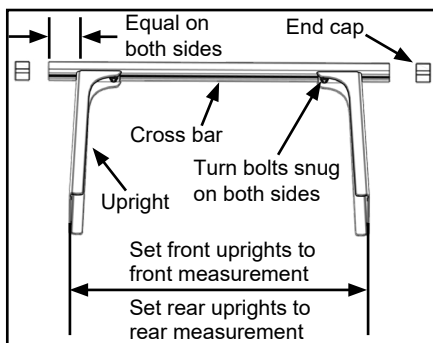

NOTE: For black steel Truck Bed Racks, see special end cap installation below.

D. Thread $3/8"$ x $3/4"$ hex bolt from bottom of end cap bolt hole into channel nut. Leave loose for now.

IMPORTANT: Ensure extended threads on channel nut face up.

NOTE: Aluminum Pro Series use $3/8"$ x $5/8"$ hex bolts.

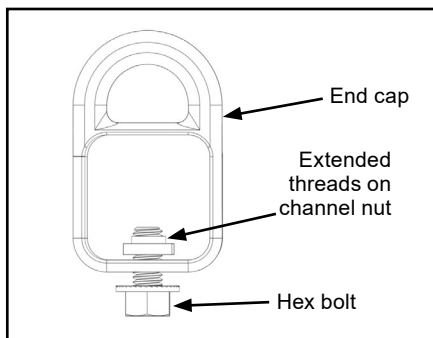

E. Slide channel nut on end cap assembly into cross bar channel. Torque bolt with $9/16"$ socket to 180 in-lbs (15 ft-lbs).

⚠ CAUTION: Over torquing hardware may damage components.

F. Repeat for end cap on opposite side.

G. Repeat Step 2 for remaining uprights and cross bar.

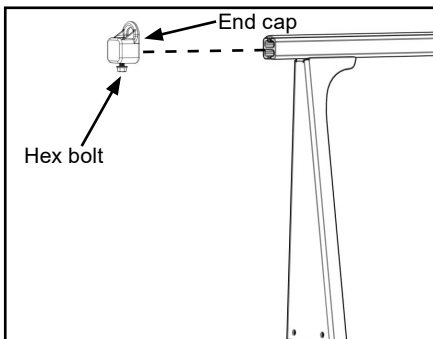

BLACK STEEL TRUCK BED RACKS

A. Install end caps to both sides of cross bar.

B. Repeat Step 2 for remaining uprights and cross bar.

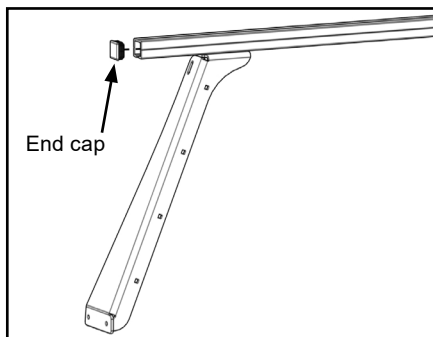

3: MOUNTING UPRIGHTS

A. Set upright assembly in the desired front position between rails.

B. Uprights should fit snug between rails. If needed, adjust cross bar mounts until uprights fit snug.

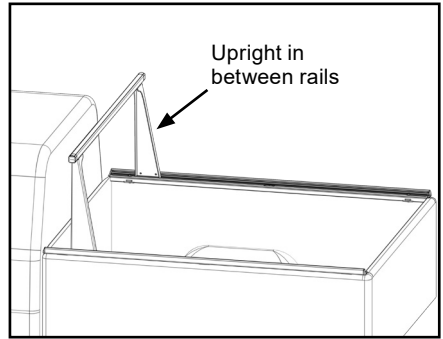

Depending on rail, perform one of the following:

RAILS WITH MOUNTING CHANNELS

A. Align channel nuts with bolt holes in uprights.

B. Thread (2) 3/8" x 3/4" hex bolts into channel nuts on both sides and finger tighten.

NOTE: Aluminum Pro Series use 3/8" x 5/8" hex bolts.

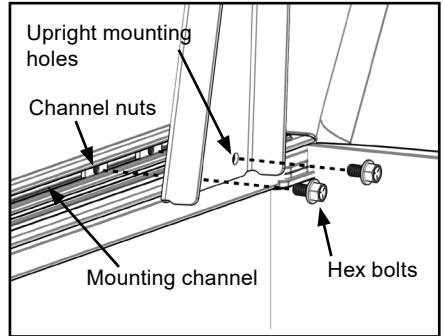

C. Check for equal distance from closest edge of box to upright. Adjust if distance to box edge is unequal. Use a ratchet with 9/16" socket to tighten bolts snug enough to prevent slippage.

D. Repeat Step 3 for remaining uprights.

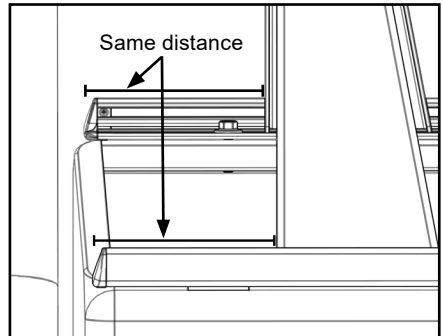

3: MOUNTING UPRIGHTS (Continued)

RACK RAILS WITH BOLT HOLES

A. Align front uprights with desired rack rail mounting holes then secure each upright with (2) 3/8" x 1" carriage bolts and nylock flange nuts.

B. Repeat Step 3 for rear uprights.

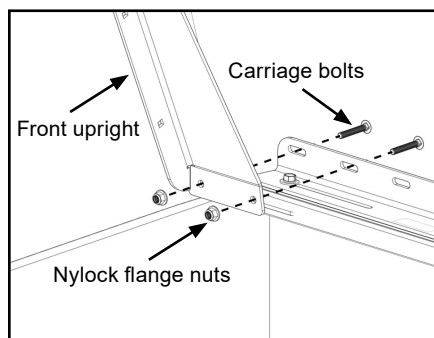

UPRIGHT MOUNTING TIPS

Verify if uprights were installed correctly:

Correct installation: The cross bar centers without binding between uprights.

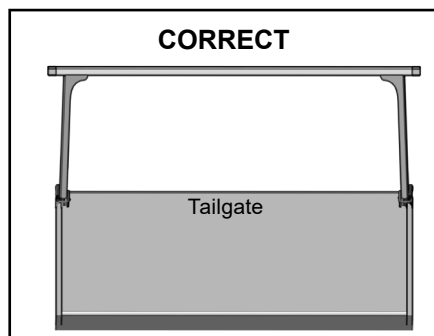

Incorrect installation: The cross bar centers with binding between uprights, forcing cross bar to bow up or down.

If required, adjust cross bar or upright mounts until uprights and cross bar installs correctly without bowing up or down.

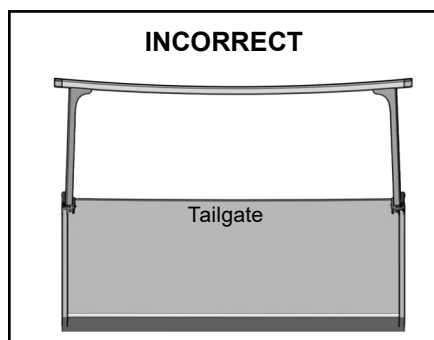

4: TIGHTENING HARDWARE

A. After verifying uprights and cross bars are installed correctly, torque upright bolts and crossbar nuts to 32 ft-lbs.

B. Periodically check hardware at the following locations:

Crossbar: All serrated flange nuts attaching cross bars to uprights.

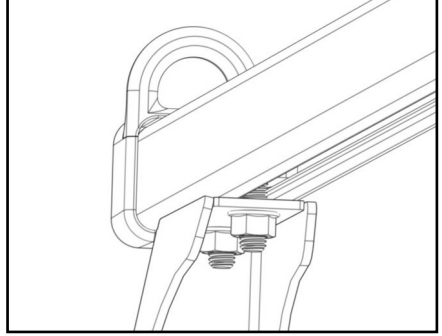

Upright: All bolts attaching uprights to rails.

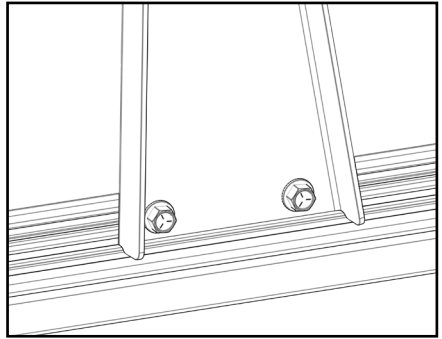

TROUBLESHOOTING

PROBLEM

Upright assembly is too wide or narrow to fit snug in between rails.

Cross bar bows up or down

Uprights are uneven

Tailgate has trouble closing

Uprights interfere with opening or closing LOMAX® Folding Hard Covers on ADARAC™ Aluminum Pro Series

SOLUTION

Loosen cross bar mounting bracket, adjust uprights to required location, tighten cross bar mounting bracket.

Check weight. Do not exceed weight rating.

Check bolts are not loose.

Loosen cross bar mounts and adjust uprights to required location.

Cross bar may be damaged and require replacement.

Ensure base of uprights are equal distance from closest end of box.

Adjust rack rails forward.

NOTE: Do not allow rack rail to pass front edge of box.

Adjust uprights evenly outward on cross bar until LOMAX® opens and closes without obstruction.

Ensure uprights are installed as far forward and backward as possible to allow LOMAX® to open and close without obstruction.

INSPECTION AND MAINTENANCE

The consumer can perform most of inspection and maintenance. It may be necessary to review instructions.

- Periodically inspect condition of all parts. Check for loose bolts and parts, tighten if needed.
- Replace damaged parts.

NOTE: Inspection and/or maintenance should also be performed anytime a malfunction is observed or suspected. If you need assistance inspecting and/or servicing your ADARAC™ call Customer Service at 866-630-8726. If you want to order a replacement part, call Customer Service. Always use original equipment replacement parts for your ADARAC™.

MANUFACTURER'S LIMITED WARRANTY

Agri-Cover, Inc. extends the following one (1) year Limited Warranty for the ADARAC™ Truck Bed Rack, ADARAC™ Aluminum M-Series, ADARAC™ Aluminum Series, ADARAC™ Aluminum Pro Series and ADARAC™ Rail and Upright Kits:

Agri-Cover, Inc. warrants for a period of one (1) year from the date of manufacture that its ADARAC™ Truck Bed Rack, ADARAC™ Aluminum M-Series, ADARAC™ Aluminum Series, ADARAC™ Aluminum Pro Series and ADARAC™ Rail and Upright Kits are free from defects in workmanship, under normal use for the vehicle model it was intended for. This Limited Warranty does not cover any damage due to accident, abuse, misuse, alteration, neglect, improper installation, or ordinary wear and tear.

Agri-Cover, Inc.'s sole obligation under this Limited Warranty is limited to the repair or replacement, at its option, of defective parts only. No labor or service allowance is given or implied. IN NO EVENT SHALL AGRI-COVER, INC. BE LIABLE FOR INCIDENTAL, CONSEQUENTIAL, OR SPECIAL DAMAGES. AGRI-COVER, INC. EXPRESSLY DISCLAIMS ANY AND ALL IMPLIED WARRANTIES OF MERCHANTABILITY AND THERE ARE NO WARRANTIES WHICH EXTEND BEYOND THE LIMITED WARRANTY DESCRIPTION CONTAINED HEREIN.

For warranty, fill out the warranty claim form at www.agricover.com/warrantyclaim or call our Customer Service Department at 866-630-8726 to determine if only a replacement part is needed or if the rack needs to be returned for inspection and repair. Goods to be returned must have a pre-authorized RA # (Return Authorization Number) - obtained by calling the number above. Mark the number on the package and ship it freight prepaid to address below. Agri-Cover, Inc. will pay freight to return goods to sender.

This Limited Warranty gives you specific legal rights and you may have other rights, which vary, from state to state.

For replacement parts, shop at adaracparts.com or call Customer Service at 866-630-8726.



Agri-Cover, Inc.
Customer Service Dept
3000 Hwy 281 SE
Jamestown, ND 58401
Phone: 866-630-8726

Hours: 8:00 am - 5:00 pm CST Monday through Friday, except Holidays