

# Warehouse Use Only

H1347B

Part #	QUANTITY	
H33B	4	<input type="checkbox"/>
A500-45B	2	<input type="checkbox"/>
K001	1	<input type="checkbox"/>
D017	1	<input type="checkbox"/>
D706	1	<input type="checkbox"/>

Picker

Initials

31.82 lbs.

Recommended Pick Weight +/- .08 lbs.

Pick Weight lbs.

Date / /

Time :  AM  
 PM

BIN #

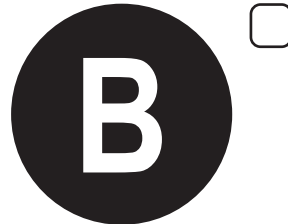

# Warehouse Use Only

Part #	QTY	
BW1	1	<input type="checkbox"/>
BW10	1	<input type="checkbox"/>
BW10-C	1	<input type="checkbox"/>

Packer

Initials

Invoice #

Date / /  AM  
 PM

Time :

Pack Time .50

Dimensions 48 x 12 x 7

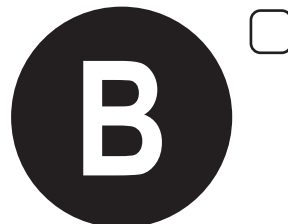





# Van & Truck Cargo System

Vantech USA www.vantech.com



## PRODUCT INFO

---

Part #: H1347B  
System: H1 Series  
Material: Steel  
Fitment: Ram ProMaster City 2015-On  
Color: Black

## REQUIRED TOOLS

---

Power Tool With Phillips Head

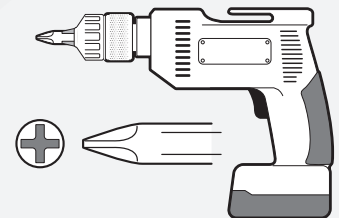

1/2" Wrench



10mm Wrench



PART #	DESCRIPTION	QTY	ITEM ITEM NOT DRAWN TO SCALE
W003	1/4" X 3/4" WASHER	8	
W021	1/4" LOCK WASHER	8	
B018	1 3/4" X 5/16" CARRIAGE BOLT	2	
B201	TAP SCREW	8	
B224	M6-25 HEX BOLT	8	
N016	5/16" PLASTIC KNOB	2	
H33	H1 MOUNTING BASE	4	
A500-45	2" X 1" X 45" CROSS BAR	2	
G100	MOUNTING SEAL	8	
G455	MOUNTING SEAT 6"	4	
G408	POLYFOAM WASHER	8	
A02	LADDER GUIDE	1	
A06	LADDER STOPPER	1	
A69	HOOK & LOOP STRAP	1	
BG055	PLASTIC BAR GUARD 55" (CUT IF NECESSARY)	2	

## Hook & Loop Strap

## Directions

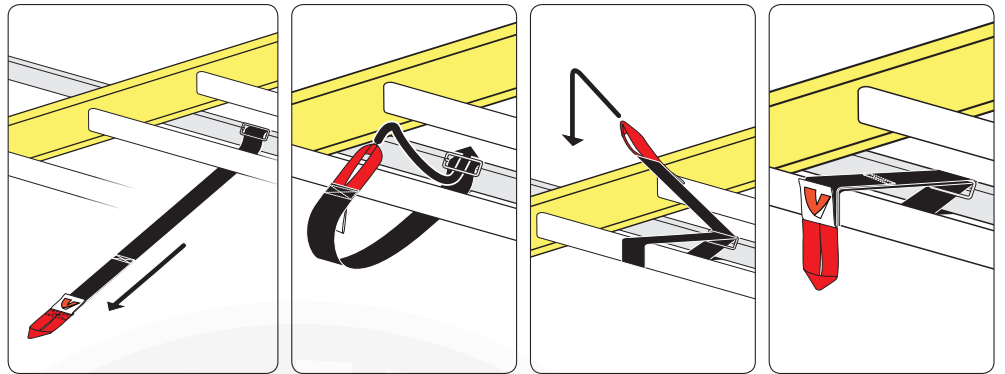
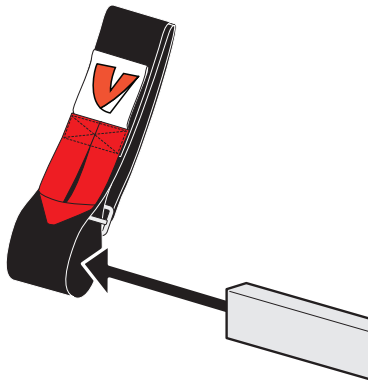

## PLASTIC BAR GUARDS FOR STEEL CROSS BARS

- Remove wax paper from plastic bar guard and adhere it to the top of the Cross Bar.

- Leave 4" on each end

