

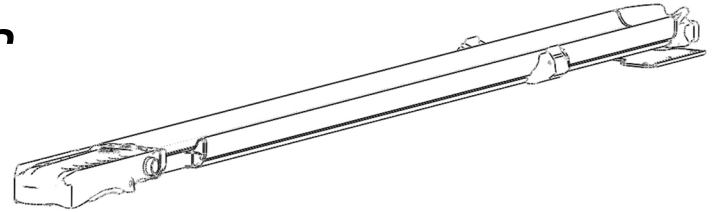

# rockymounts™ **SwitchHitter**



## Guidelines

This carrier is intended for SQUARE, ROUND, and SLOTTED crossbars (RockyMounts™ Ouray, Thule™ AeroBlade, Yakima™ Whispbar & JetStream, Rhino Rack™ Vortex, Audi™, BMW™, Mini™, Porsche™, VW™, & Volvo™). Use on other bars is not covered under our warranty.  
Crossbar spread: minimum 16" (41cm), maximum 48" (122cm).  
Do not exceed the load capacity of your vehicle's roof rack.  
Bicycle weight limit: 35lbs (16kg) factory, 45lbs (20kgs) RockyMounts™, Thule™, Yakima™, & Rhino Rack™ crossbars.  
Forks equipped with carbon fiber dropouts or forks without safety tabs are not covered under warranty.  
Some thru-axles enter from the left and some from the right. Position rack accordingly for easiest access.

## Parts Included

A: Wheel Tray Assembly	F: 4mm Hex Wrench	K: Flat Washers
B: 12x100mm Axle	G: Wheel Strap	L: T-Slot Plates
C: 15x110mm Axle	H: Nylon Spacer	M: Rear Bracket
D: 9mm Quick Release w/ Sleeve	I: M6x14 Bolt	N: Plastic Bolt Spacer
E: 5mm Hex Wrench	J: M6x 8 Bolt	O: M6x55 Bolt

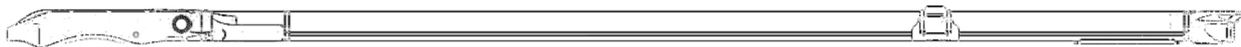

**A (1x)**

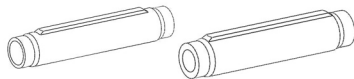

**B (1x)**

**C (1x)**

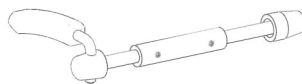

**D (1x)**

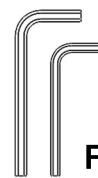

**F (1x)**

**E (1x)**



**G (1x)**

\*lock cores not included

\*15x100mm axle preinstalled

### Slotted Crossbars

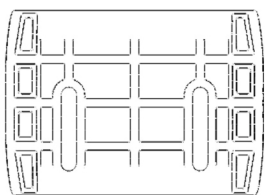

**H (1x)**



**I (2x)**



**J (1x)**



**K (3x)**



**L (3x)**

### All Non-Slotted Crossbars



**M (2x)**



**N (2x)**



**O (2x)**

**This package includes two mounting options:** Proceed to “**All Non-Slotted Crossbar Mounting**” if you have bars **without** center mounting slot (Thule™ square, Yakima™ round, & factory). Proceed to “**Slotted Crossbar Mounting**” if you have bars **with** center slot (RockyMounts™ Ouray, Thule™ AeroBlade, Yakima™ Whispbar & JetStream, Rhino Rack™ Vortex, BMW™, Audi™, Volvo™, Mercedes™, Porsche™, Mini™, & VW™)

**START HERE: ALL NON-SLOTTED CROSSBAR MOUNTING (PART 1)**

**1 Remove Top Cap**

Remove top cap from head by lifting up finger tab

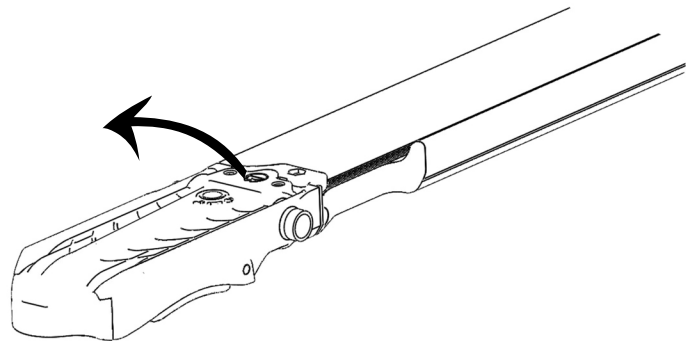

**2 Loosen Strap**

Loosen M6 bolt with 5mm hex wrench.  
Unhook strap

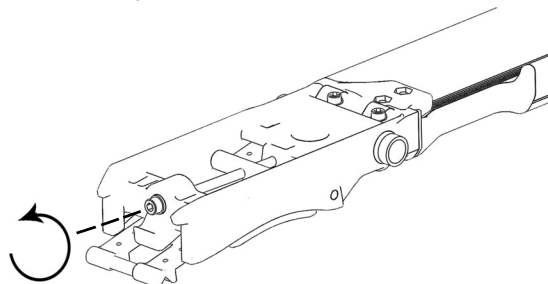

**3 Position Rack**

Place head onto front crossbar. Slide rear plate above rear crossbar. Rack must be positioned between towers

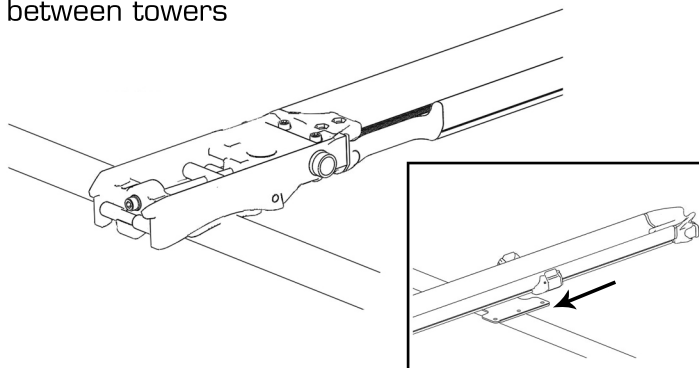

**4 Install Rack**

FIRST: Reattach strap around front crossbar, centering head over crossbar. NEXT: Install rear bracket using two M6 bolts and plastic spacers. Tighten M6 bolt with 5mm hex wrench. Tighten two bolts on rear bracket

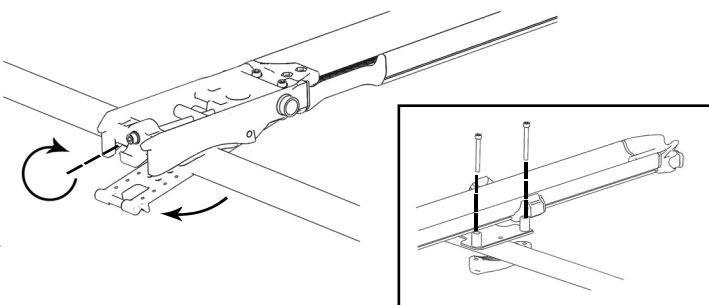

Proceed to ALL STYLES OF CROSSBARS (PART 2)

**START HERE: SLOTTED CROSSBAR MOUNTING (PART 1)**

**1 Remove Top Cap**

Remove top cap from head by lifting up finger tab

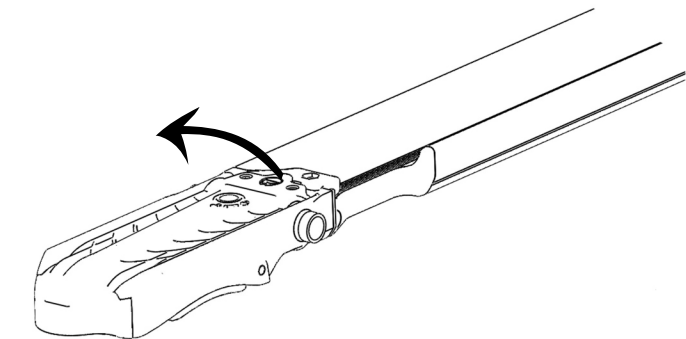

**2 Remove Bolt**

Remove M6 bolt by holding nut in place with flat head screwdriver and loosening M6 bolt with 5mm hex wrench

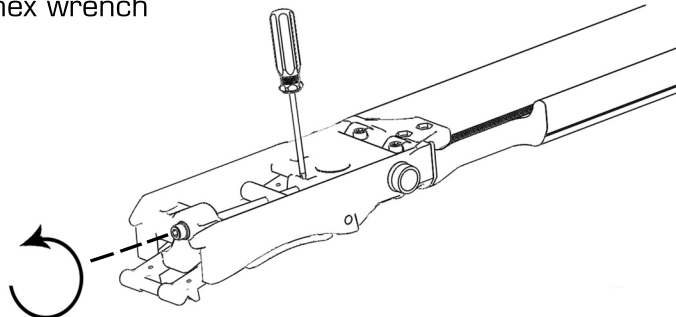

### 3 Remove Strap

Remove steel rod from strap. Use pliers to flatten loops on strap and pull out from bottom of head

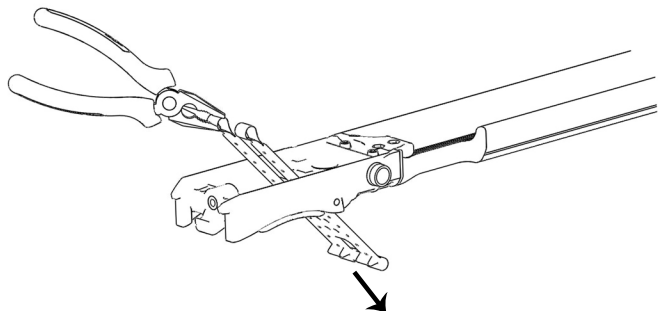

### 4 Install Plastic Spacer

Replace rubber pads with snap-in plastic spacer on bottom of head

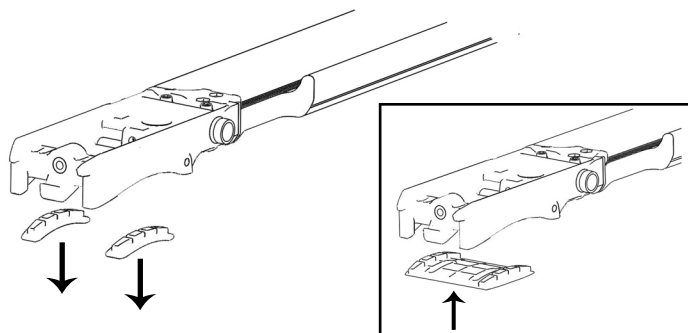

### 5 Install T-Slot Plates

Loosely install two #3 plates through two holes on head using two M6x14 bolts with washers. Use M6x8 bolt with washer to install remaining plate onto rear bracket

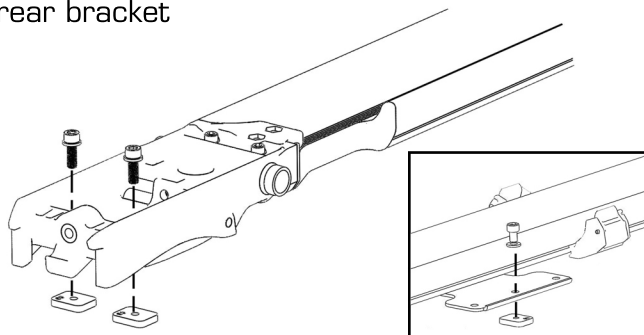

### 6 Install Rack on Crossbars

Remove end caps and rubber stripping from crossbars. Simultaneously slide front and rear plates into t-slot in crossbars. Position rack and securely tighten all three bolts

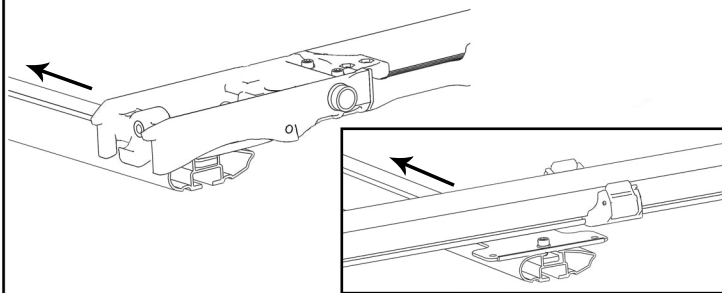

### ALL STYLES OF CROSSBARS (PART 2)

Proceed to ALL STYLES OF CROSSBARS (PART 2)

### 7 Wheel Strap & Top Cap

Install wheel strap into buckles. Reinstall top cap onto head

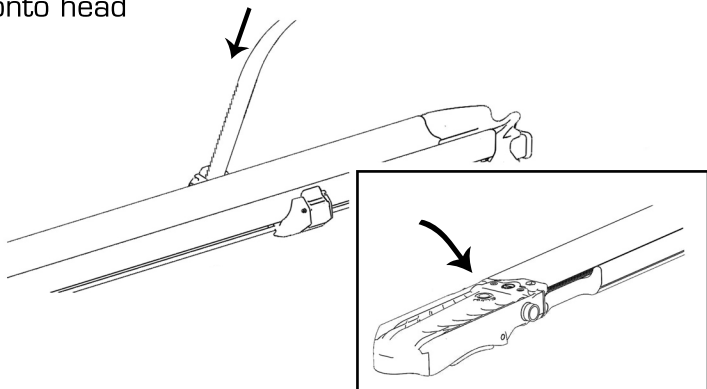

### 8 Lock Cores (Not Included)

Remove plastic cap on top cap using key. Insert key into core and line up large protruding metal wafer between tabs in housing. Install lock cores

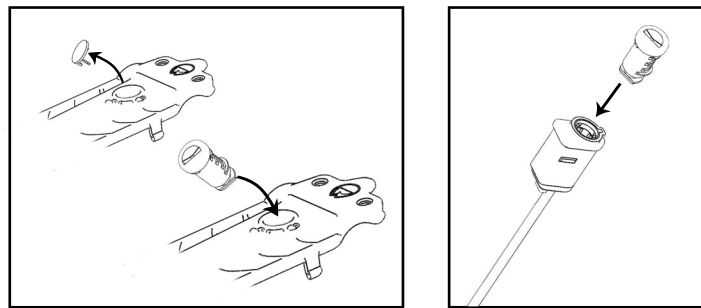

## LOADING BIKE

### 1 Install Axle

Determine bike axle size and install corresponding axle, centering in head, by loosening M5 bolts with 4mm hex wrench. 15x100 axle comes preinstalled. For 9mm QR, install QR into 15x100 axle

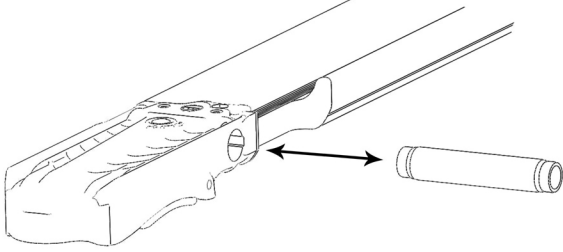

### 2 Load Bike

Remove front wheel and place bike onto rack with fork dropouts securely seated on axle. Install thru axle or tighten QR and secure bike by closing QR handle (QR should close with tension). If you are unsure, please consult your local dealer or RockyMounts, Inc directly

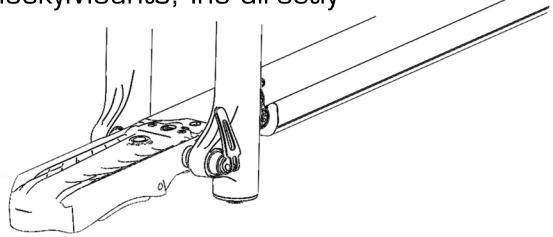

### 3 Secure Rear Wheel & Bike

Feed rear wheel strap through rear wheel into buckle and pull tight. Double check bike is secure by rocking bike back and forth. Fork and wheel should be properly seated and not move

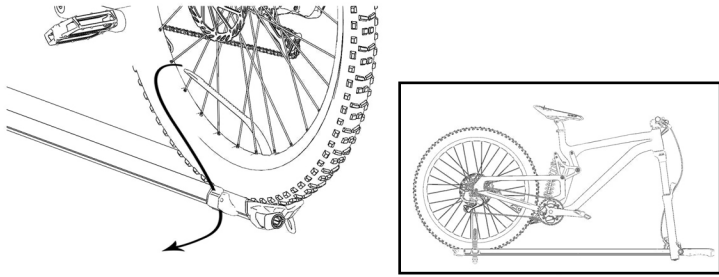

### 4 Locking Bike

Pull cable out from rear end cap. Feed cable through rear triangle of bike and lock cable to metal boss

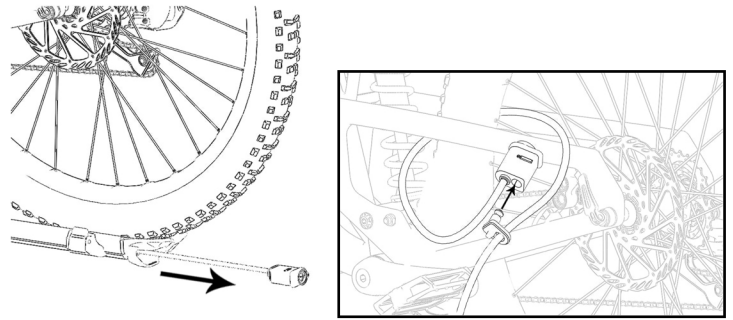

## Warnings

Remove Baby Seats, Panniers, U-Locks, or items that could detach from the bicycle.  
Do not use bicycle covers, bicycle bras, or bikes equipped with rear disc wheel.  
Not intended for off road use.  
Locks are only deterrents to thieves, RockyMounts, Inc. cannot be held liable for stolen bicycles.  
Remove rack before entering a car wash.  
Check all fastenings (nuts, bolts, straps, and skewer) before each use.  
Once a year, remove rack from car. Clean and inspect for damage.

## Lifetime Warranty

Thank you for purchasing a RockyMounts™ product. We take pride in providing a great customer experience and manufacturing products that enable our customers to get their gear to their next colorful adventure.

As of January 1, 2014, RockyMounts™ products are covered for life to the original purchaser when used in accordance with the instruction manuals' assembly, installation and use guidelines.

If you feel something broke before it's time; please email us at [ride@rockymounts.com](mailto:ride@rockymounts.com) or call us at 800.873.1871. For the most efficient service, email a digital photo (we need this photo to verify the problem) of the product in questions, a brief description of the situation, and your purchase receipt. Our techs will respond within one business day. Most of the time we'll replace the part in question, but we may ask for more details.

RockyMounts, Inc. warranty only covers RockyMounts, Inc. products. It does not cover theft, or damage to vehicles and/or equipment.

All products purchased prior to Jan 1, 2014 are covered by a one-year warranty; see your product manual for details.



**This package includes two mounting options:** Proceed to “**All Non-Slotted Crossbar Mounting**” if you have bars **without** center mounting slot (Thule™ square, Yakima™ round, & factory). Proceed to “**Slotted Crossbar Mounting**” if you have bars **with** center slot (RockyMounts™ Ouray, Thule™ AeroBlade, Yakima™ Whispbar & JetStream, Rhino Rack™ Vortex, BMW™, Audi™, Volvo™, Mercedes™, Porsche™, Mini™, & VW™)

**START HERE: ALL NON-SLOTTED CROSSBAR MOUNTING (PART 1)**

**1 Remove Top Cap**

Remove top cap from head by lifting up finger tab

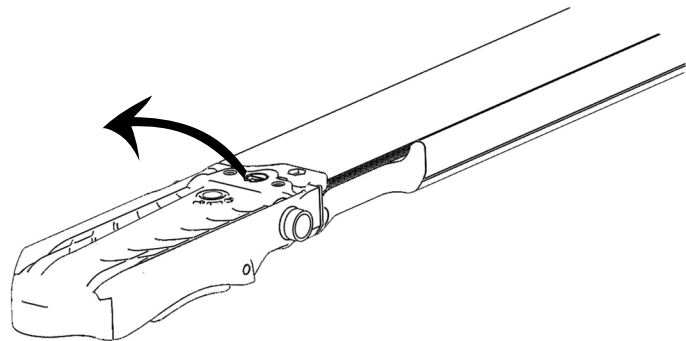

**2 Loosen Strap**

Loosen M6 bolt with 5mm hex wrench.  
Unhook strap

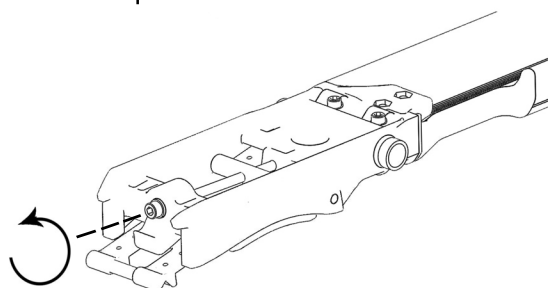

**3 Position Rack**

Place head onto front crossbar. Slide rear plate above rear crossbar. Rack must be positioned between towers

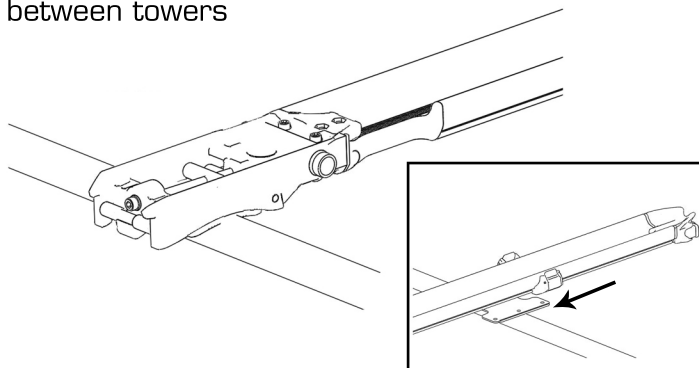

**4 Install Rack**

FIRST: Reattach strap around front crossbar, centering head over crossbar. NEXT: Install rear bracket using two M6 bolts and plastic spacers. Tighten M6 bolt with 5mm hex wrench. Tighten two bolts on rear bracket

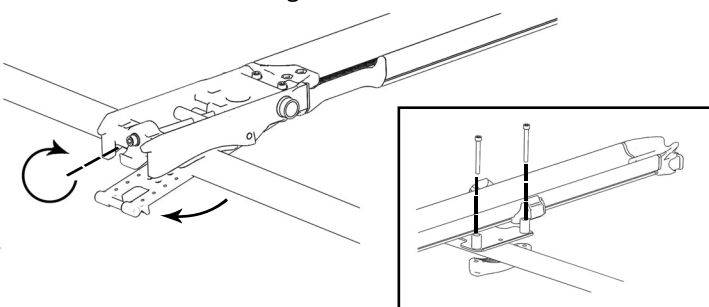

Proceed to ALL STYLES OF CROSSBARS (PART 2)

**START HERE: SLOTTED CROSSBAR MOUNTING (PART 1)**

**1 Remove Top Cap**

Remove top cap from head by lifting up finger tab

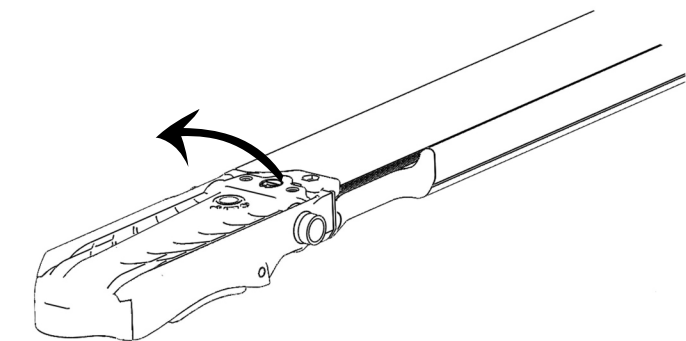

**2 Remove Bolt**

Remove M6 bolt by holding nut in place with flat head screwdriver and loosening M6 bolt with 5mm hex wrench

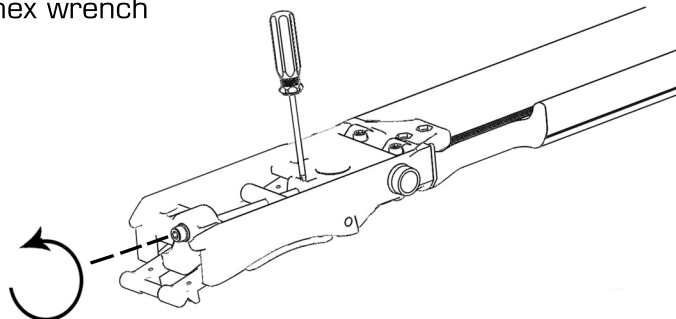

### 3 Remove Strap

Remove steel rod from strap. Use pliers to flatten loops on strap and pull out from bottom of head

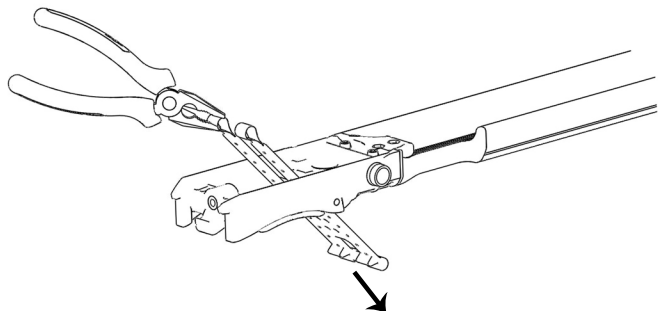

### 4 Install Plastic Spacer

Replace rubber pads with snap-in plastic spacer on bottom of head

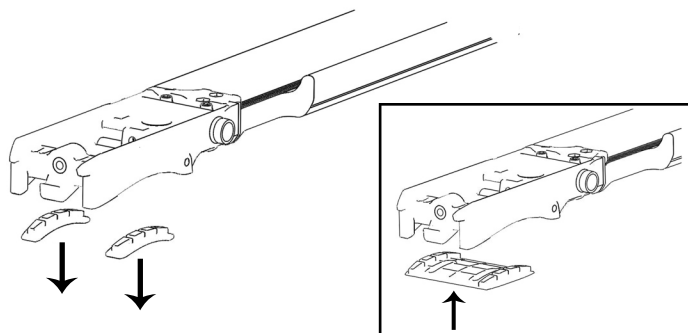

### 5 Install T-Slot Plates

Loosely install two #3 plates through two holes on head using two M6x14 bolts with washers. Use M6x8 bolt with washer to install remaining plate onto rear bracket

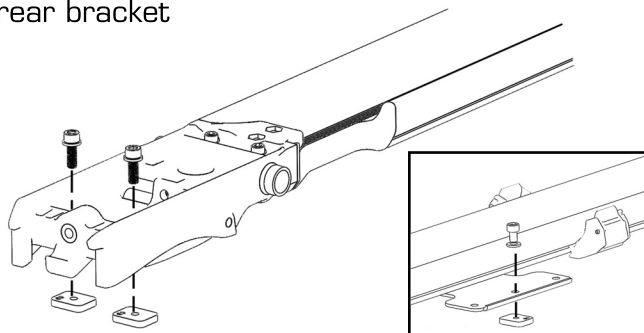

### 6 Install Rack on Crossbars

Remove end caps and rubber stripping from crossbars. Simultaneously slide front and rear plates into t-slot in crossbars. Position rack and securely tighten all three bolts

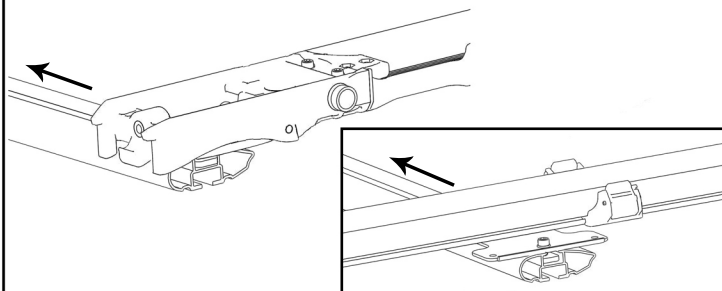

### ALL STYLES OF CROSSBARS (PART 2)

Proceed to ALL STYLES OF CROSSBARS (PART 2)

### 7 Wheel Strap & Top Cap

Install wheel strap into buckles. Reinstall top cap onto head

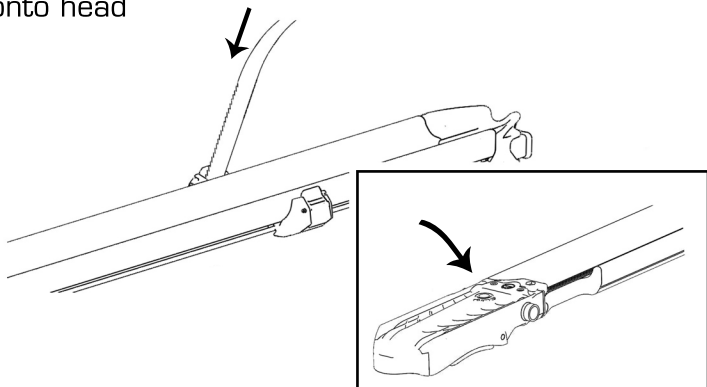

### 8 Lock Cores (Not Included)

Remove plastic cap on top cap using key. Insert key into core and line up large protruding metal wafer between tabs in housing. Install lock cores

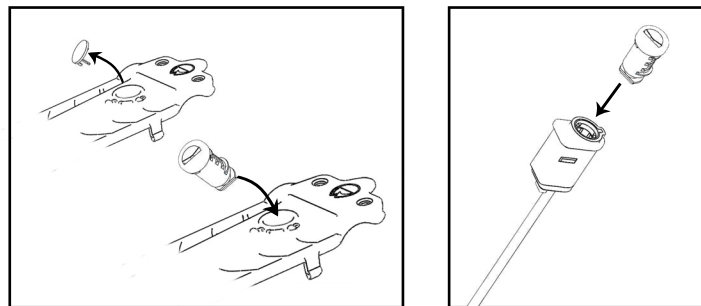

## LOADING BIKE

### 1 Install Axle

Determine bike axle size and install corresponding axle, centering in head, by loosening M5 bolts with 4mm hex wrench. 15x100 axle comes preinstalled. For 9mm QR, install QR into 15x100 axle

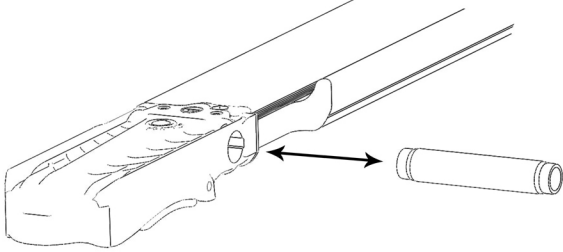

### 2 Load Bike

Remove front wheel and place bike onto rack with fork dropouts securely seated on axle. Install thru axle or tighten QR and secure bike by closing QR handle (QR should close with tension). If you are unsure, please consult your local dealer or RockyMounts, Inc directly

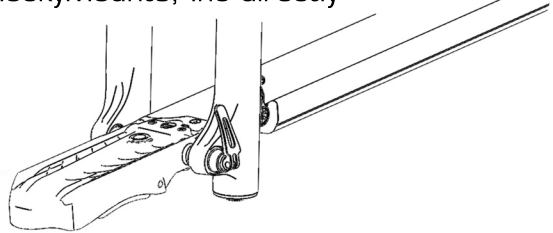

### 3 Secure Rear Wheel & Bike

Feed rear wheel strap through rear wheel into buckle and pull tight. Double check bike is secure by rocking bike back and forth. Fork and wheel should be properly seated and not move

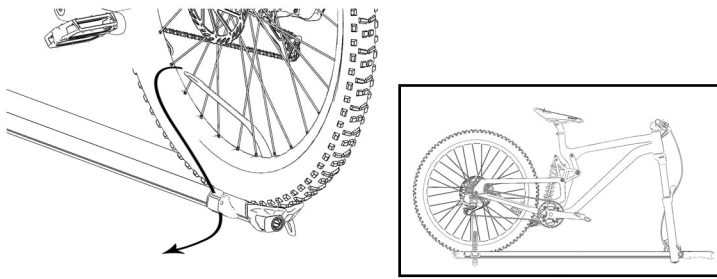

### 4 Locking Bike

Pull cable out from rear end cap. Feed cable through rear triangle of bike and lock cable to metal boss

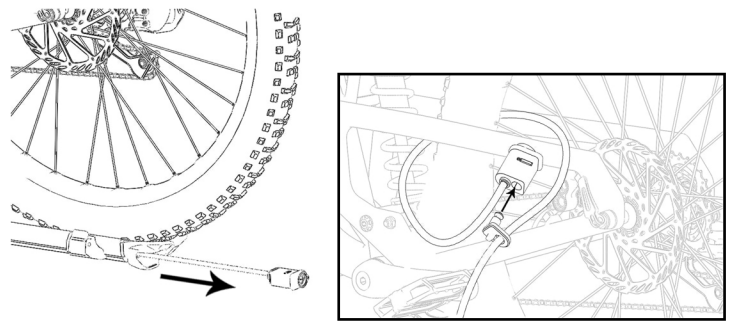

## Warnings

Remove Baby Seats, Panniers, U-Locks, or items that could detach from the bicycle.  
Do not use bicycle covers, bicycle bras, or bikes equipped with rear disc wheel.  
Not intended for off road use. Not intended for use on trailers or towed vehicles.  
Locks are only deterrents to thieves, RockyMounts, Inc. cannot be held liable for stolen bicycles.  
Remove rack before entering a car wash.  
Check all fastenings (nuts, bolts, straps, and skewer) before each use.  
Once a year, remove rack from car. Clean and inspect for damage.  
Lubricate Quick Release every 1-2 months using chain lube or oil.  
Dust and dirt can build up over time in Quick Release. If QR begins to stick, lubricate immediately.

## Lifetime Warranty

Thank you for purchasing a RockyMounts™ product. We take pride in providing a great customer experience and manufacturing products that enable our customers to get their gear to their next colorful adventure.

As of January 1, 2014, RockyMounts™ products are covered for life to the original purchaser when used in accordance with the instruction manuals' assembly, installation and use guidelines.

If you feel something broke before it's time; please email us at [ride@rockymounts.com](mailto:ride@rockymounts.com) or call us at 800.873.1871. For the most efficient service, email a digital photo (we need this photo to verify the problem) of the product in questions, a brief description of the situation, and your purchase receipt. Our techs will respond within one business day. Most of the time we'll replace the part in question, but we may ask for more details.

RockyMounts, Inc. warranty only covers RockyMounts, Inc. products. It does not cover theft, or damage to vehicles and/or equipment.

All products purchased prior to Jan 1, 2014 are covered by a one-year warranty; see your product manual for details.